

TRAFFIC MANAGEMENT PLAN DURING PIPELINE INSTALLATION FROM AMPANG RESERVOIR TO AU3 RESERVOIR (CH2550-CH3200) (SHEET 2)

SCOPE OF WORKS : OPEN CUT
 : INSTALLATION OF PIPELINE
 : REINSTATEMENT WORKS

Advanced Warning Signs
 Type 'A', 'B', 'C', 'D', 'E', 'I', & 'J'

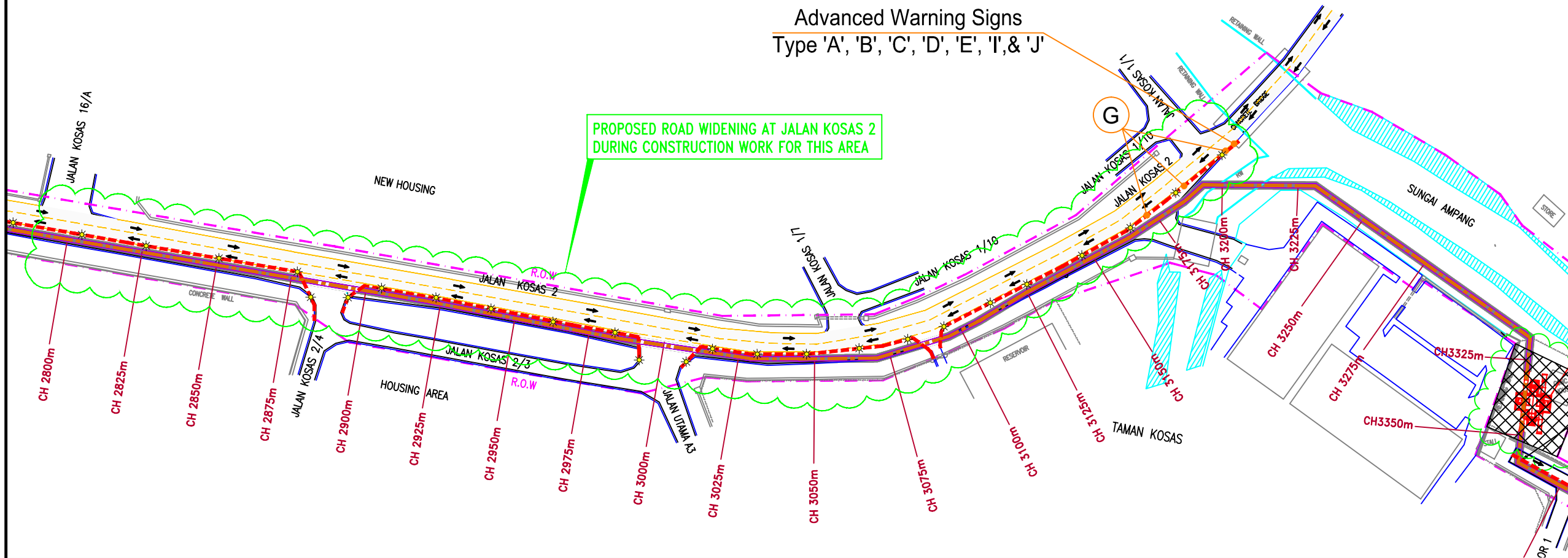

ADVANCE WARNING SIGNS

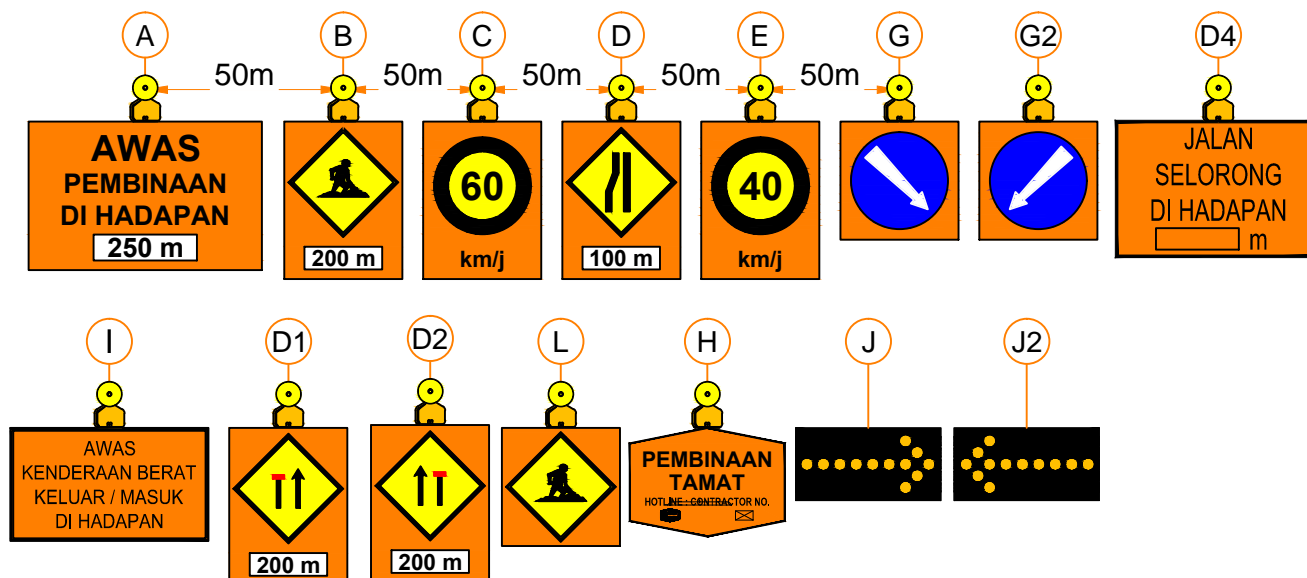

REMARKS :

- 1. BLINKERS : Straight stretch - 30 m interval
 Taper - 10 m interval

LEGEND

	EXISTING ROAD		MONSOON DRAIN / RIVER
	TRAFFIC FLOW		FLAGMAN
	CHANNELIZING DEVICES		INGRESS/EGRESS
	PIPELINE		WORK AREA
			BLINKERS

FOR INFORMATION ONLY

EMPLOYER:

 Pengurusan Aset Air Berhad
 Tingkat 24, Menara Multi Purpose, Capital Square,
 8, Jalan Munshi Abdullah,
 50100 Kuala Lumpur
 Tel: 603 26145555 Fax: 603 26145588

EMPLOYER'S STAMP & SIGNATURE

CONSULTANT:

 SMHB Sdn. Bhd.
 In association with
 R\PROJECTS\T0801\LANHILL.tif

 KTA Tenaga Sdn Bhd.
 PROJECT DESIGN OFFICE
 Langat 2 WTP and Water Reticulation - Phase 1
 No. 38, Jalan 1/76D, Desa Pandan,
 55100 Kuala Lumpur, MALAYSIA
 Tel : +603-92811122
 Fax : +603-9283 9618
 Email : LRAL2@langat2.com
 Website : www.langat2.com

PROJECT:
 PROPOSED DEVELOPMENT OF LANGAT 2 WATER TREATMENT PLANT AND WATER RETICULATION SYSTEM IN SELANGOR DARUL EHSAN / WILAYAH PERSEKUTUAN KUALA LUMPUR

APPROVED BY AUTHORITY/UTILITY/SERVICE PROVIDER

THIS DRAWING IS PREPARED BY:

CONSULTANT'S CHOP & SIGNATURE

REVISION			
REV.	DATE	DESCRIPTION	APR

CONTRACT PACKAGE:
 PAKEJ 6 : Membekal Dan Memasang Paip Air Terawat Utama Dari Kolam Air Ampang Ke Kolam Air AU3

DRAWING TITLE:
 TRAFFIC MANAGEMENT PLAN DURING PIPELINE INSTALLATION FROM AMPANG RESERVOIR TO AU3 RESERVOIR (CH2550-CH3200) (SHEET 2)

DATE: APRIL 2016	SCALE: AS SHOWN
DRAWN: -	CHECKED: -
DESIGNED: -	APPROVED: -
DRAWING NO: TMP/SUB/PIPELINE/PACKAGE6/027	REVISION: 00